



# E-Estate Palawan Development Corporation

## Beachfront Lots / Resort Developments



*Outstanding beach house property*

Property Code: BL109

Type of ownership: Titled

Price: PHP \_\_\_\_\_

Total area: 35,242 Square Meters

GPS: 10° 24' 0.10" N 119° 8' 43.28" E

Location: Pamuyan, Port Barton



View of beach from ocean



View of ocean from beach



View of left side beach



View of right side beach



View of beach interior



View of coral dip pool

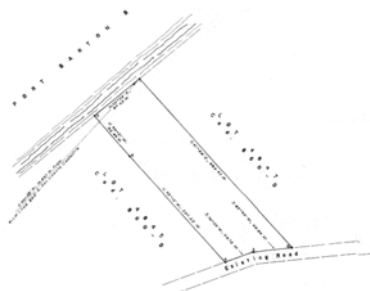

View of property tax map



View of satellite area map

### OVERVIEW:

This property has a 91 ft x 77 ft concrete house with 4 bedrooms and 3 Comfort rooms, (2 bedrooms has own CR). It is fully fenced by barbwire with more than 1 hectare flat land with front and back gates. More or less 2 hectares of the property is swampy and could be utilized as fishpond. It also has an overlooking hilly land with live creek in it. Front of the house is planted with different fruit trees such as; bananas, black cherry, guava, guyabano, star apple, calamansi, dalandan, mango, pineapples, tambis, jackfruits, avocado, rambutan, mangosteen, orange and newly planted grapes.

### TRAVELLING:

From city proper of Puerto Princesa to Port Barton it can be travel by car in about 3 to 4 hours, and from Port Barton to Pamuyan, it will take only 10 minutes ride by boat.

### FACILITIES:

It has existing Native house, power house for generator, and DREAM Satellite. Water source can be obtained from small waterfalls and creek. Globe and Smart cellular coverage are also available at the area.

### POTENTIALS:

It is already well developed for residential or vacation house, but it is really good for beach resort. 91 x 77 feet concrete house is ideal for resort center, underneath is a huge space for any desired projects. Its wide flat beach front offers a very good area for cottages.

**E-Estate Palawan Development Corporation**

**PH: 011-63-9209526835 FX: 011-63-48-4337792**

**# 334, 2nd Floor, Moraga Rizal Ave. Puerto Princesa City**  
**sales@palawanproperty.com / www.palawanproperty.com**